







## **Accommodation**

A centrally located three bedroom end terrace house, handily situated just a short walk from the city centre and Ripon's amenities. The property is tucked away in a small cul-de-sac, whilst also backing onto the river skell and enjoyed a lovely open aspect.

On the ground floor there is an entrance hall, living room with fireplace and a stunning open plan kitchen/diner, fitted with a stylish range of kitchen units and with double doors leading to the rear garden. The first floor offers a landing, three bedrooms and a part tiled house bathroom, fitted with a white suite including a bath with shower and glazed screen over.

Externally there is two allocated parking spaces to the front of the house, whilst a passageway and gate lead to the rear garden. The rear garden is a delight, fully enclosed and offering lovely views over the river behind, plus a woodland aspect. The garden is fully paved and designed with ease of maintenance in mind.

Offered for sale with no onward chain, the property is sure to be of interest to first time buyers or those looking to downsize, whilst it would also make an ideal buy to let investment.









Floorplan

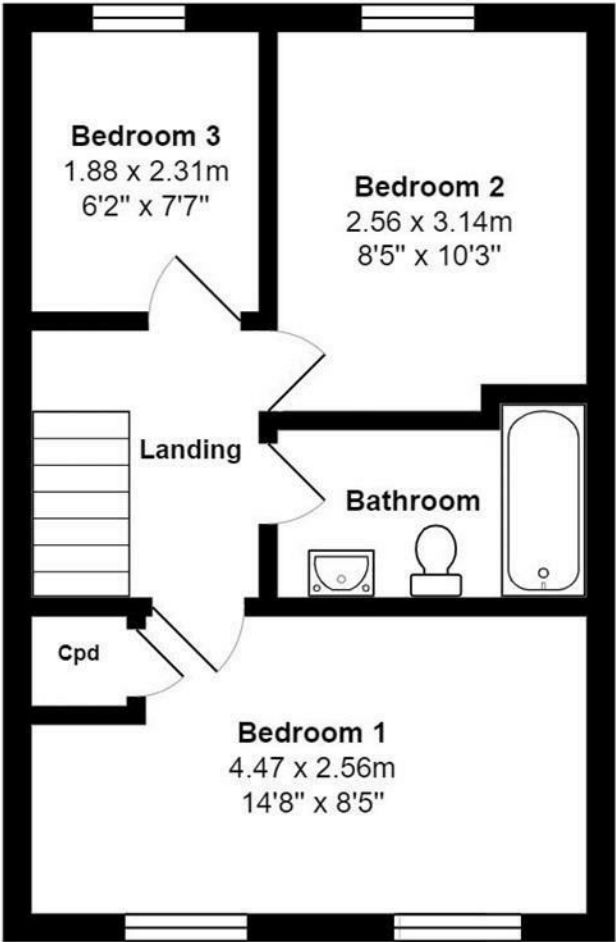
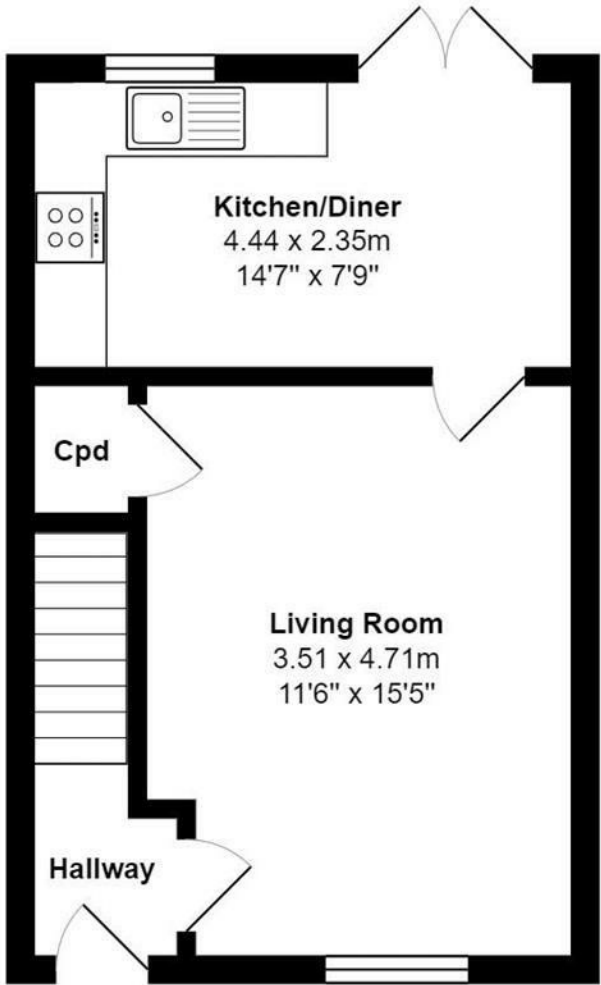

## EPC

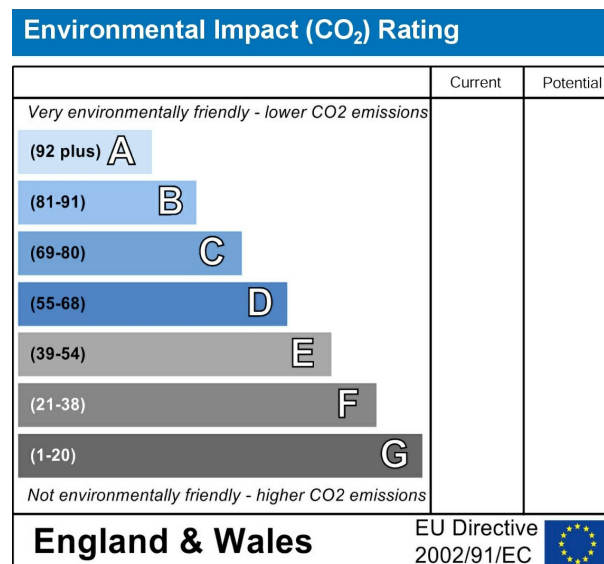
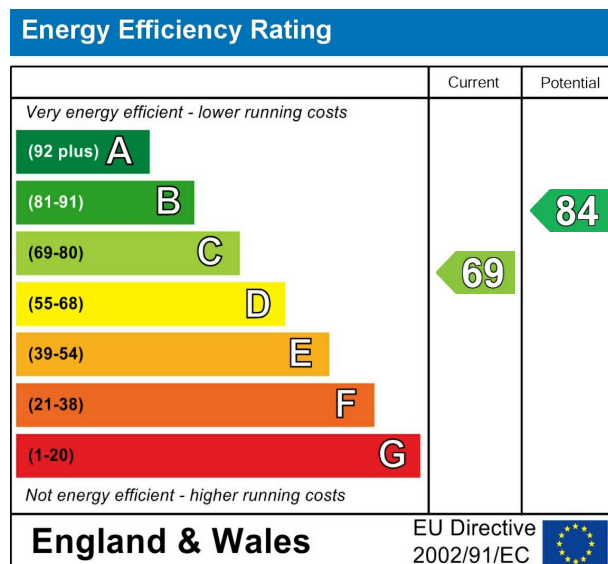

VIEWING BY APPOINTMENT ONLY - 01765 602233 - [sales@davislund.co.uk](mailto:sales@davislund.co.uk) - [www.davislund.co.uk](http://www.davislund.co.uk)

**MONEY LAUNDERING REGULATIONS 2003** - Intending purchasers will be asked to produce identification and proof of financial status when an offer is received. We would ask for your co-operation in order that there will be no delay in agreeing the sale.

Davis & Lund Ltd trading as Davis & Lund, registered office: 5a Kirkgate, Ripon, HG4 1PA. Registered in England No 10034416. Registered for VAT No 243 2008 51

Davis & Lund Ltd have prepared these property details on the seller's behalf. Davis & Lund Ltd have taken reasonable steps to check the content, but no information should be taken as a statement of fact. All measurements are approximate and should be taken as a guide, potential purchasers should satisfy themselves as to the accuracy. Floorplans are produced as a guide and they are not to scale. All fixtures and fittings are not included in the sale, unless stated. Heating systems, electrics, services and appliances have not been tested and no warranty is given to their working order

